

Tip 3/2 Thermoplastic Hose



Applications

Waterblast : Heat exchanger tube cleaning

Hydraulics : Pressure test equipment (valves, tooling and control panels), hydraulic tools (instrumentation packages for gauges, control of service equipment, hydraulic jacks, hydraulic tools)

Inner Core : Polyoxymethylene (POM)
Pressure Support : 2 layers of high-tensile steel wire
Outer Cover : Polyamide (PA)
Colour : Green
Temperature : [-30 °C to +60 °C]

Lenght (m)	Part No
10	00.70.1300
15	00.70.1310
20	00.70.1320

Inner Diameter Ø mm	Outer Diameter Ø mm	Working Pressure * Bar	Burst Pressure Bar	Bend Radius mm	Weight kg/m	Inner Diameter of Insert Ø mm	Outer Cover Material	Outer Cover Diameter Ø mm
3.4	6.9	1000	2500	60	0.072	2	Carbon Steel	8.9

* Safety factor between burst pressure and working pressure as well as test pressure depends on operating conditions. For gaseous media a safety factor of 1:6 is to be applied and the outer cover is to be pricked. The indicated working pressure refers to the hos only. Depending on the used fitting the permitted working pressure of a hose assembly can be less.

Fitting
Fitting Type : Male
Thread : M6
Material : Carbon Steel

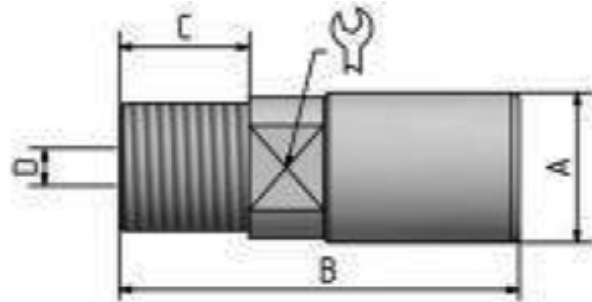

Fitting
Fitting Type : Female
Thread : G1/4"
Material : Carbon Steel

